

ALL DIMENSIONS TO BE CHECKED ON SITE  
 NO DIMENSIONS TO BE SCALED FROM THIS DRAWING  
 DRAWING IS TO BE READ IN CONJUNCTION WITH RELEVANT CONSULTANTS DRAWINGS

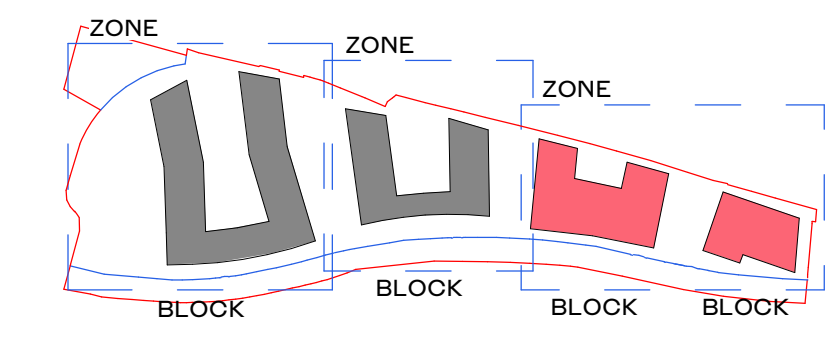

**SITE DRAWINGS LEGEND:**  
 REFER TO BARRET MAHONY CIVIL ENGINEERING DRAWINGS FOR ALL DRAINAGE/ ROAD INFORMATION.  
 SURVEY INFORMATION PROVIDED BY JONES ENGINEERING ON 23.4.2019.  
 PLEASE REFER TO THE PAUL HOGARTH COMPANY LANDSCAPE DRAWINGS FOR ALL INFORMATION ON EXISTING AND PROPOSED TREES, MATERIAL FINISHES AND LAYOUT. ANY REFERENCE TO TREES/ HARD OR SOFT LANDSCAPING IN THIS DRAWING ARE INDICATIVE ONLY.

- EXISTING BUILDING
- PLANNING APPLICATION SITE BOUNDARY
- PLANNING APPLICATION OWNERSHIP OF APPLICANT



ALL APARTMENT TYPES SHOULD BE READ IN CONJUNCTION WITH DRAWING NO.S P1601, P1602, P1603, P1604 AND HOUSING QUALITY

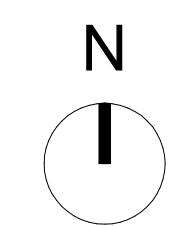

REV	DATE	DESCRIPTION	CHK	DRN
P2	26/11/2019	ISSUED FOR PLANNING APPROVAL	DB	OJ
P1	05/09/2019	ISSUED FOR PAC REQUEST	DB	OJ

STATUS CODE DESCRIPTION  
**ISSUED FOR PLANNING APPROVAL**

CLIENT  
 Atlas GP Limited

PROJECT  
 Project Claremont

DRAWING  
 BLOCK C&D - FOURTH FLOOR PLAN

PROJECT NUMBER  
 950520

DATE  
 26/11/19

SCALE: A1:  
 As indicated

DRAWN/CHECKED:  
 OJ/ DB

REVISION	DRAWING NUMBER	STATUS CODE
P2	CLR-HJL-03-04-DR-A-1014CD	A1

1 ZONE 03 - BLOCK C&D - FOURTH FLOOR  
 1:200

**Henry J Lyons**

Architecture + Interiors  
 henryjlyons.com

+353 1 888 3333  
 info@henryjlyons.com

53.54 Pearse Street  
 Dublin D02 K466